

ENPHASE CABLE
 BLACK - L1
 RED - L2
 BLUE - L3
 WHITE - NEUTRAL
 GREEN - GROUND

JUNCTION BOX

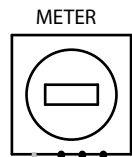

TO METER
OR AC DISTRIBUTION
PANEL

1 - 3 POLE 20 AMP
CIRCUIT BREAKER
PER BRANCH CIRCUIT

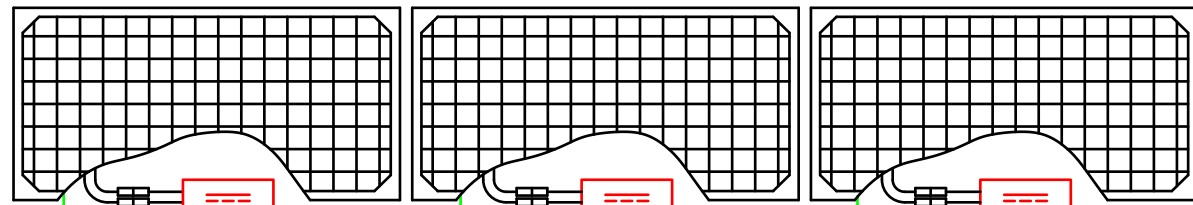
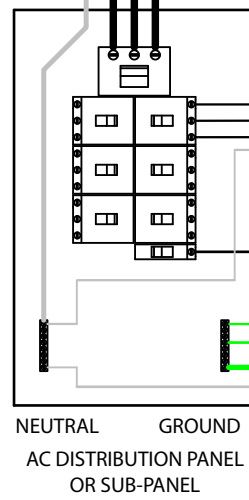

PHASE A-B

PHASE C-A

PHASE B-C

TERMINATOR
INSTALLED ON
END OF CABLE

UP TO 25 M215s
PER AC BRANCH CIRCUIT

ENVOY COMMUNICATIONS GATEWAY



ETHERNET CONNECTION
TO BROADBAND ROUTER

120 Vac POWER CABLE

IMPORTANT: Make sure to measure the line-to-line and the line-to-neutral voltage of all service entrance conductors prior to installing any solar equipment. The voltages for the 208 Vac rated microinverters should be within the following ranges:
 line to line - 183 to 229 Vac, line to neutral - 106 to 132 Vac.

FIELD WIRING DIAGRAM
208 VAC THREE PHASE